

Quest Power Air Mover A3000

Installation, Operation and Maintenance Instructions

– Read and Save These Instructions –

This manual is provided to acquaint you with the Quest Power Air Mover A3000 air mover so that installation, operation and maintenance can proceed successfully. Ultimate satisfaction depends on the quality of set up and a thorough understanding of this equipment. The Quest Power Air Mover A3000 is built around tested engineering principles and has passed a thorough inspection for quality of workmanship and function.



Quest Power Air Mover A3000:

- Less than 2.5 amps
- Automatic hour meter displays site run time
- 20 ft AC cord with cord management
- Units interlock for ease of stacking during storage and handling
- Weighs 2.5 lbs less than competitive units
- Over 3000 CFM on high

Patent 7,331,759



Therma-Stor[®] LLC

Driven by performance. Powered by design.™

4201 Lien Rd.
Madison, WI 53704
www.QuestProtect.com

Phone 608-237-8400
Toll-Free 1-866-933-7486

Table of Contents

Quest Power Air Mover A3000 Features 1

1. Safety Information 3

2. Intended Application 4

3. Safety Certifications..... 4

4. Specifications 4

5. Power Requirements..... 4

 5.1 Recommended Use..... 4

 5.2 Integrated Cord Wrap 4

6. Applications 5

 6.1 Placement 5

 6.2 Orientation of Directional Drying..... 5

7. Operating Instructions 6

8. Operator Panel Features 6

 8.1 3-Position Drying Selector Switch..... 6

9. Maintenance 6

 9.1 Servicing 6

 9.2 Cleaning..... 6

10. Replacement Parts and Optional Accessories.... 7

11. Wiring Diagram 7

12. Warranty 8

Serial No. _____

Purchase Date ____/____/____

Dealer's Name _____



1. Safety Information

- Do not operate the unit with a cut or frayed power cord. Replace cord if it becomes damaged.
- Do not unplug the unit by pulling on the cord. Grasp the plug firmly and pull it out of the wall socket or power receptacle.
- Always use a grounded outlet.
- Never operate electrical equipment in standing water.
- Never operate with the safety grills removed. Personal injury may result.
- Do not stick your fingers or other objects through the safety grills.
- Do not restrict airflow to the unit. This may cause the unit to overheat.
- Unit should never be serviced or cleaned while it is plugged in.
- Do not sit or stand on the unit or use as a shelf or table.
- Before leaving an Axial Air Mover unattended, ensure children do not have access to the equipment. Do not allow children to play with or near the unit or in its air flow.
- To reduce the risk of fire or electric shock, do not use this air mover with any solid-state speed control device.
- Do not route cord under furniture or appliances.

LIRE ET CONSERVER CES INSTRUCTIONS

- Risque de choc électrique Peut causer des blessures ou la mort. Débrancher toutes les alimentations en courant électrique à distance avant l'entretien ou le nettoyage.
- Ne pas utiliser l'appareil avec un cordon d'alimentation coupé ou effiloché.
- Ne pas débrancher l'appareil en tirant sur le cordon. Tenir la fiche fermement et la tirer hors de la prise murale ou la prise d'alimentation électrique.
- Toujours utiliser une prise mise à la terre.
- Ne jamais utiliser l'équipement électrique dans de l'eau stagnante.
- Ne jamais utiliser sans les grilles de protection. Des blessures risquent d'en résulter.
- Ne pas passer les doigts ou d'autres objets dans les grilles de protection.
- Ne pas diminuer le débit d'air arrivant jusqu'à l'appareil. L'appareil risque de trop chauffer.
- Ne pas s'asseoir ou se tenir debout sur l'appareil; ne pas l'utiliser comme étagère ou table.
- Avant de laisser un appareil aéraulique axial sans surveillance, s'assurer que les enfants n'ont pas accès à l'équipement. Ne pas laisser les enfants jouer avec l'appareil ou à proximité de l'appareil ou dans l'air qu'il projette.
- Pour réduire le risque d'incendie ou de choc électrique, ne pas utiliser ce ventilateur avec un dispositif de commande de vitesse à semi-conducteurs.



2. Intended Application

The Quest Power Air Mover A3000 has changed the drying industry by minimizing overall drying time on water restoration jobs. The Quest Power Air Mover A3000 uses patent pending FOCUS Technology to maximize air velocity across floors and along walls for longer distances. By maximizing the air velocity, water evaporates more quickly from the carpet, pad, sub-floor, wall, and sill plate.

3. Safety Certifications

The Quest Power Air Mover A3000 (P/N 4028330) conforms to UL STD 507. Certified to CAN/CSA STD C22.2 No. 113.

4. Specifications

Part No.	4028330
Power	1/4 hp 1-phase 110/120 VAC 2-speed 4-pole, PSC Electric Motor.
CFM	Approximately 3000
Cord	20 ft Power Cord
Current Draw	2.5 Amps
Voltage	115 VAC
Warranty	Year One - 100% parts and labor (all components) Year Two - 100% parts only (all components) Years Three through Seven - Only materials and workmanship of the housing are covered.
Dimensions	
	Cabinet
Width	19.9"
Height	19.5"
Depth	15.2"
Weight	29.5 Lbs

5. Power Requirements

5.1 Recommended Use

The Quest Power Air Mover A3000 draws 2.5 amps. .

Note: Standard 115 VAC electrical outlets.



Figure 1: Cord wrap



5.2 Integrated Cord Wrap

The Quest Power Air Mover A3000 features integrated cord management. Wrap the cord around the cord wrap as shown and secure the cord with the clasp on the plug.

6. Applications

6.1 Placement

Quest Axial Air Movers with FOCUS Technology will allow placing the Quest Power Air Mover A3000 at an angle nearly parallel to the wall.

The test graph shown in Figure 2 depicts immediate air flow at the FOCUS Technology corner. The Quest Power Air Mover A3000 sustains this air flow for more than 20 feet and maximizes the air velocity across the floor and along the wall when placed the at 4.5° angle from the wall.

By touching the front edge of the output side of the Quest Power Air Mover A3000 against the wall and rotating the rest of the unit against the wall, the restoration professional will place the axial air mover at 4.5° due to the housing's built-in design. Industry experts agree placing air movers 45° angle to the wall wastes air flow and reduces the performance by forcing air up the wall.

The best set up angle for quickly and completely drying the sill plate is 4.5°. Set-up angles greater than 4.5° may be used under unique circumstances such as corner air flow and structure variations. Set-up angle should never exceed 23°.

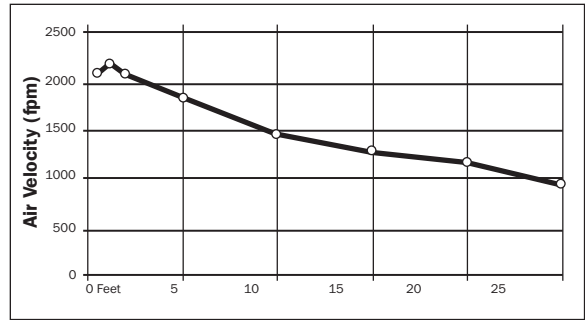

Figure 2: Airflow of the Quest Power Air Mover A3000 measured 3.5" parallel to wall.



Figure 3: 4.5° to wall as shown

6.2 Orienting of Directional Drying System

The Quest Power Air Mover A3000 dries in counter-clockwise and clockwise directions for optimum ease of use. The Quest Power Air Mover A3000 ships with rubber feet on one side of the unit for counter-clockwise drying.

When employing clockwise drying (such as the need to dry a door jamb), simply rotate the axial air mover 90° so the FOCUS Technology corner points and floor for the clockwise drying.

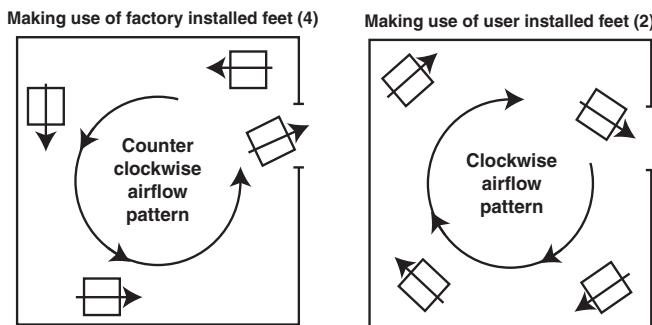
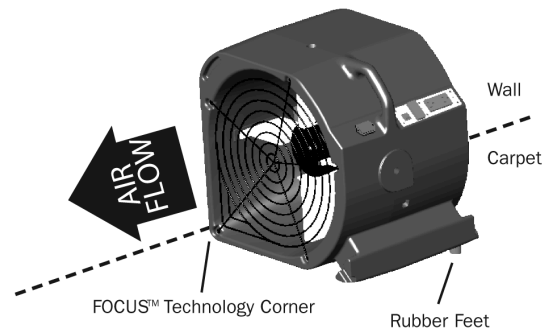
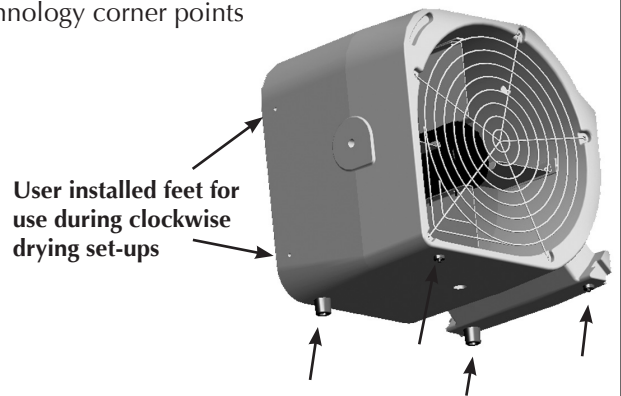

Figure 4: Birds eye view of room set-up



Factory installed feet for use during counter clockwise drying

Figure 5: Clockwise feet locations



7. Operating Instructions

The Quest Power Air Mover A3000 as packaged is ready to be put into service. Inspect the unit completely for any shipping damage. Place the unit on the ground. Orient the unit so the desired air flow direction is the same as the arrow indicator sticker in the FOCUS Technology corner on the interior of the unit. Plug the unit into a grounded outlet and select the drying mode shown in Figure 6.

CAUTION: The Quest Power Air Mover A3000 consumes 2.5 Amps.

8. Operator Panel Features

8-1 Position Drying Selector Switch

The 3-position drying mode selector switch. This switch is used to select the Quest Power Air Mover A3000's mode of operation. The 3 modes of operation are OFF, LOW or HIGH.

OFF - The Quest Power Air Mover A3000 is not drying.

LOW - The Quest Power Air Mover A3000 is in "Normal" Drying mode. This mode provides rapid drying and very quiet operation.

HIGH - The Quest Power Air Mover A3000 is in "Fast" drying mode. This mode provides the industries most rapid drying while maintaining low noise operation.

9. Maintenance

WARNING: Disconnect the unit from power before servicing or cleaning. Replace the wire safety grill after servicing or cleaning.

9.1 Servicing

Before each use inspect for damage, blocked inlet or outlet, or any excess buildup of foreign material.

When the Quest Power Air Mover A3000 is first turned on, check for excessive vibration. If the unit vibrates excessively or if blade rubs on housing, turn off the unit immediately. Have a service technician inspect the unit to locate the problem.

9.2 Cleaning

The housing is made of a durable and washable polyethylene. When cleaning, the use of solvents is NOT recommended.

When washing inside the unit, disconnect the unit from its power source. Protect the 3-position switch with a cloth. Clean inner barrel, grills and blade. Wipe down motor exterior with a damp cloth. If the motor gets wet during cleaning, simply allow ample time for motor to dry out completely before restarting.

If you wash the Quest Power Air Mover A3000 and do not plan to use it within 24 hours, allow the fan to drip dry for 10 minutes and then let run for 5 minutes.



10. Replacement Parts and Optional Accessories

Contact the factory at 1-866-933-7486 to order replacement parts, or optional accessories

Part No.	Description	Part No.	Description
4025204	Switch, Rocker, On-Off-On	4025299	Stand Hardware Kit
4025206	Grill, Safety, Intake	4030073	Motor
4025207	Grill, Safety, Exhaust	4025095	Blade
4025460	Quest Power Air Mover A3000		
Stand			

11. Wiring Diagram

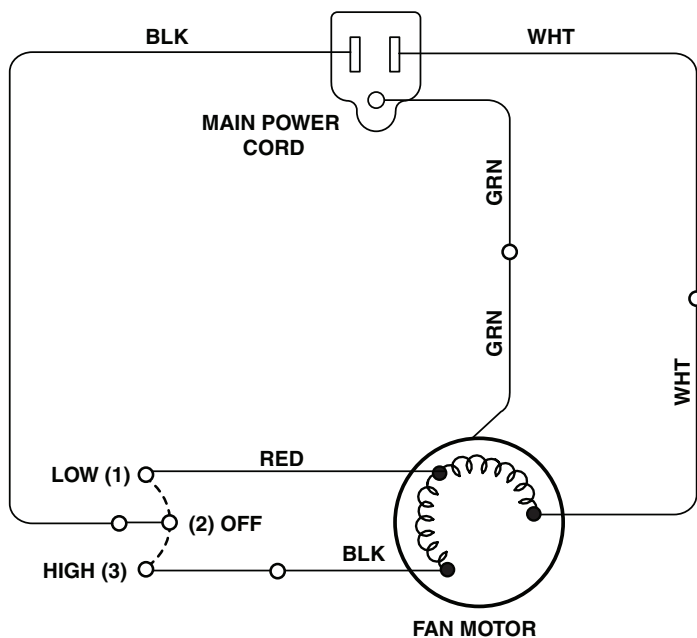

Quest Power Air Mover A3000 Limited Warranty

Warrantor:

Therma-Stor LLC
4201 Lien Rd
Madison, WI 53704
Telephone: 1-866-933-7486

Who Is Covered: This warranty covers Quest Power Air Mover A3000.

First Year Warranty: 100% parts and labor (all components)

Second Year Warranty: 100% parts only (all components)

Years Three through Seven: Only materials and workmanship of the housing are covered.

If a defect in materials or workmanship occurs within the warranty period, Therma-Stor LLC will repair or replace the defect.

End-User Responsibilities: Warranty service must be performed by a servicer authorized by Therma-Stor Products. To obtain warranty service you must obtain a return material authorization (RMA). To obtain an RMA you must present proof of purchase or (lease), by use of a warranty card, original sales receipt or other reasonable and reliable means.

To obtain an RMA call Therma-Stor LLC at the above number and ask for the Therma-Stor LLC Service Department, which will then issue an RMA# and arrange for, at our option, either repair or replacement.

Freight: Freight to and from the servicer is the responsibility of the end-user. The end-user is responsible for normal care and proper return packaging.

Limitations and Exclusions: This warranty does not cover any defect, malfunction, etc. resulting from misuse, abuse, lack of normal care, corrosion, freezing, tampering, modification, unauthorized or improper repair or installation, accident, acts of nature or any other cause beyond Therma-Stor LLC's reasonable control.

If any Quest Power Air Mover A3000 part is repaired or replaced, the new part shall be warranted for the balance of original warranty (but all warranty periods will be extended by the period of time, if any, that the Quest Power Air Mover A3000 with FOCUS Technology is out of service while awaiting covered warranty service).

Warranty service will be performed during normal working hours.

UPON THE EXPIRATION OF THE WRITTEN WARRANTY APPLICABLE TO THE QUEST Power Air Mover A3000 OR ANY PART THEREOF, ALL OTHER WARRANTIES IMPLIED BY LAW, INCLUDING MERCHANTABILITY AND FITNESS FOR A PARTICULAR PURPOSE, SHALL ALSO EXPIRE. ALL WARRANTIES MADE BY THERMA-STOR LLC ARE SET FORTH HEREIN, AND NO CLAIM MAY BE MADE AGAINST THERMA-STOR BASED ON ANY ORAL WARRANTY. IN NO EVENT SHALL THERMA-STOR LLC, IN CONNECTION WITH THE SALE, INSTALLATION, USE, REPAIR OR REPLACEMENT OF ANY QUEST Power Air Mover A3000 OR PART THEREOF BE LIABLE UNDER ANY LEGAL THEORY FOR ANY SPECIAL, INDIRECT OR CONSEQUENTIAL DAMAGES INCLUDING WITHOUT LIMITATION WATER DAMAGE (THE END USER SHOULD TAKE PRECAUTIONS AGAINST SAME), LOST PROFITS, DELAY, OR LOSS OF USE OR DAMAGE TO ANY REAL OR PERSONAL PROPERTY.

Some states do not allow limitations on how long an implied warranty lasts, and some do not allow the exclusion or limitation of incidental or consequential damages, so one or both of these limitations may not apply to you.

Legal Rights: This warranty gives you specific legal rights, and you may also have other rights which vary from state to state.

